

HORIZONTAL FEED MIXERS

DOUBLE AUGER SX60

CAPACITY MINIMUM POWER AUGER SPEED NUMBER OF BLADES

6 m³

50 hp

22,22 Rpm

92

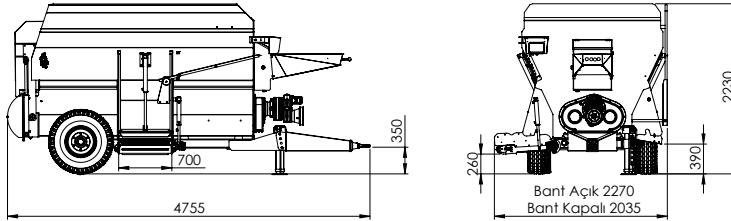

About the Product

The İzelmak Horizontal Twin Auger Feed Mixer SX60 is ideal for medium-sized cattle farms. With its twin auger system and U-shaped knives, it ensures homogeneous mixing and reduces feed waste. Designed for tractor-mounted use, its durable construction delivers high efficiency for 60–80 head of cattle.



Features	Values
CAPACITY	6 m ³
MIXING SYSTEM	Double Auger
NUMBER OF BLADES	92
MIN. POWER REQUIREMENT	50 HP
PTO TRANSFER	540
TRANSMISSION TYPE	Planet
AUGER SPEED	22,22 Rpm
WHEEL SIZE	11,5x80x15,3
LOADING BUCKET CAPACITY	100 kg
FEED DISCHARGE DIRECTION	Right - Left
JACK	Mecanic
CONVEYOR BELT	Standard (right)
LENGHT	4755 mm
HEIGHT	2230 mm
WIDHT	2035 mm
TOTAL WIDHT	2270 mm
BODY SHEET	5 mm
BASE PLATE	10 mm
EMPTY WEIGHT	2800 kg
FULL WEIGHT	4000 kg

● The specified features vary depending on the added options.